

# QBSE BUILD STEP 3

Locate the parts completed in steps 1 & 2 along with 4) 1 1/2" 6/32 screws and lock nuts and 2) 1" 6/32" screws and lock washers.

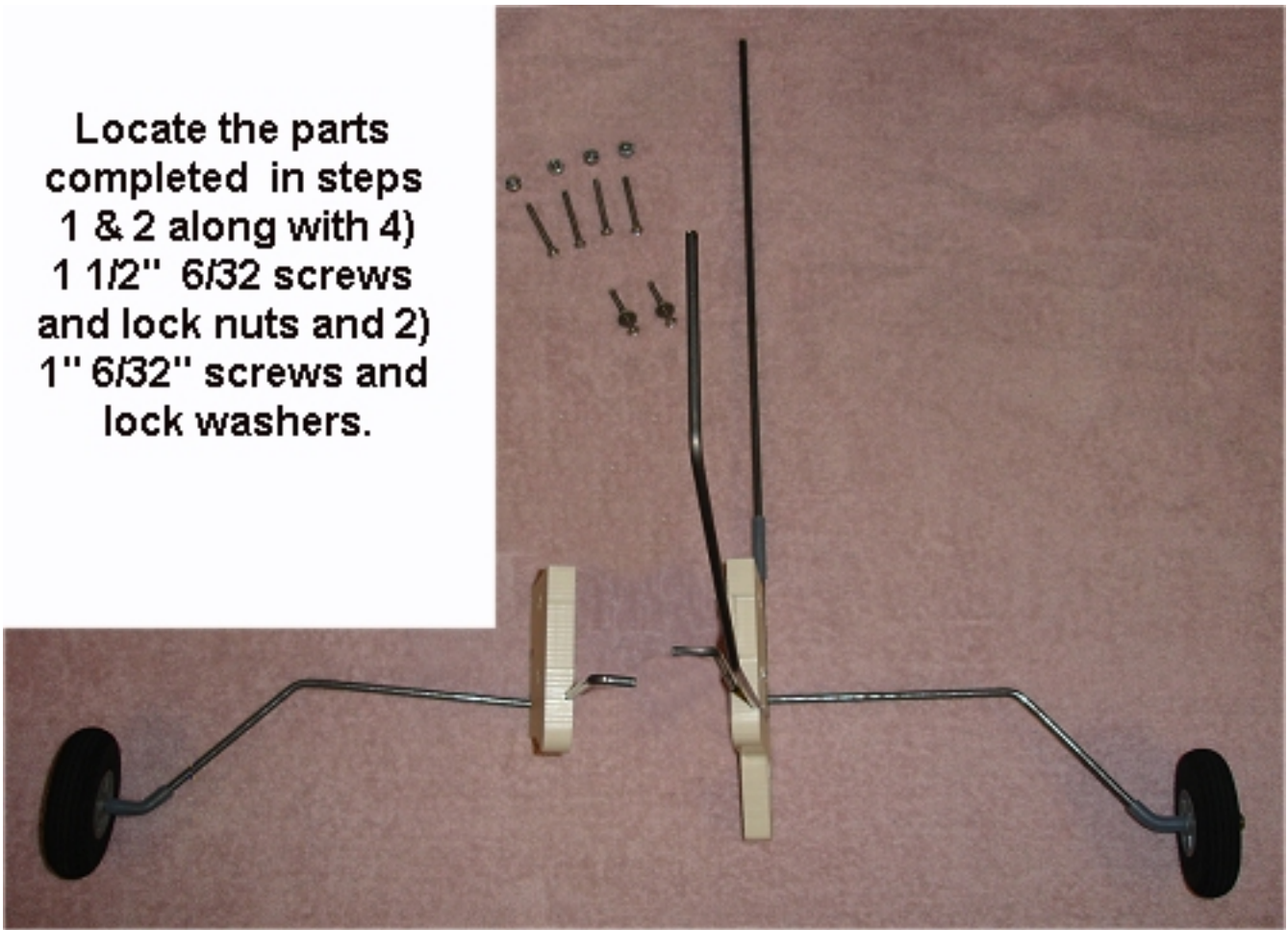

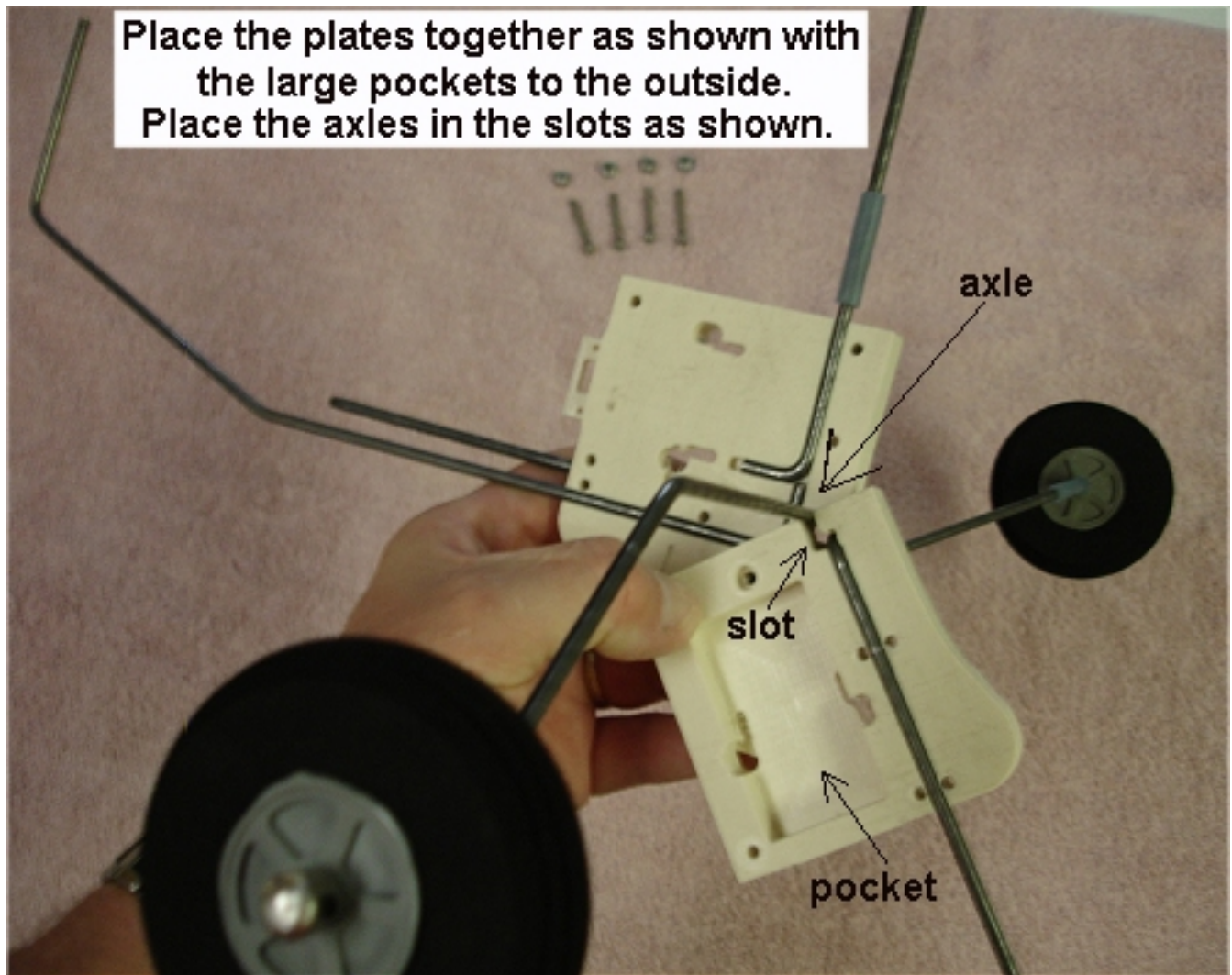

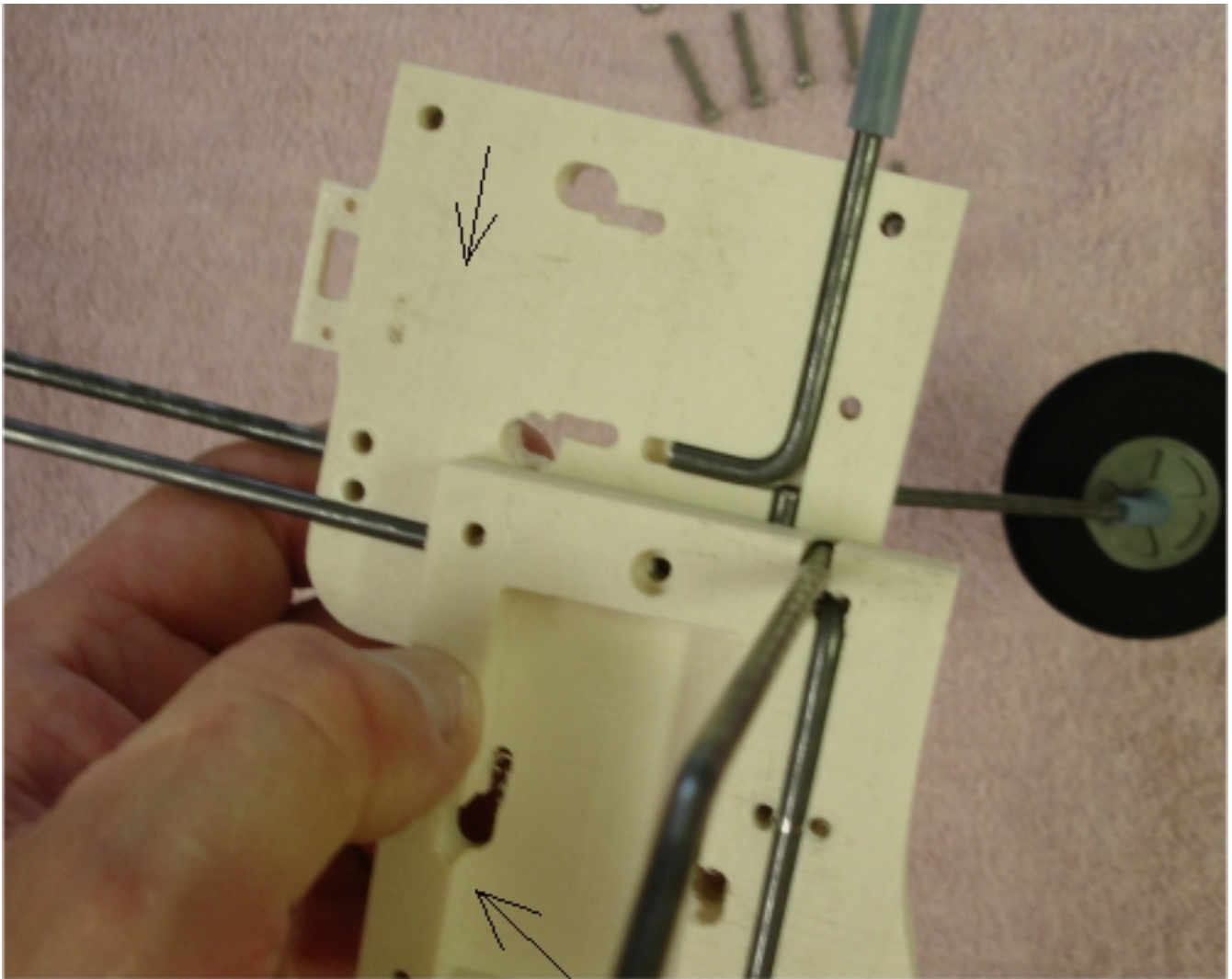

**Slowly rotate the parts and the rear axles will feed into the plate slots.**

**Rotate the parts  
until they match.**

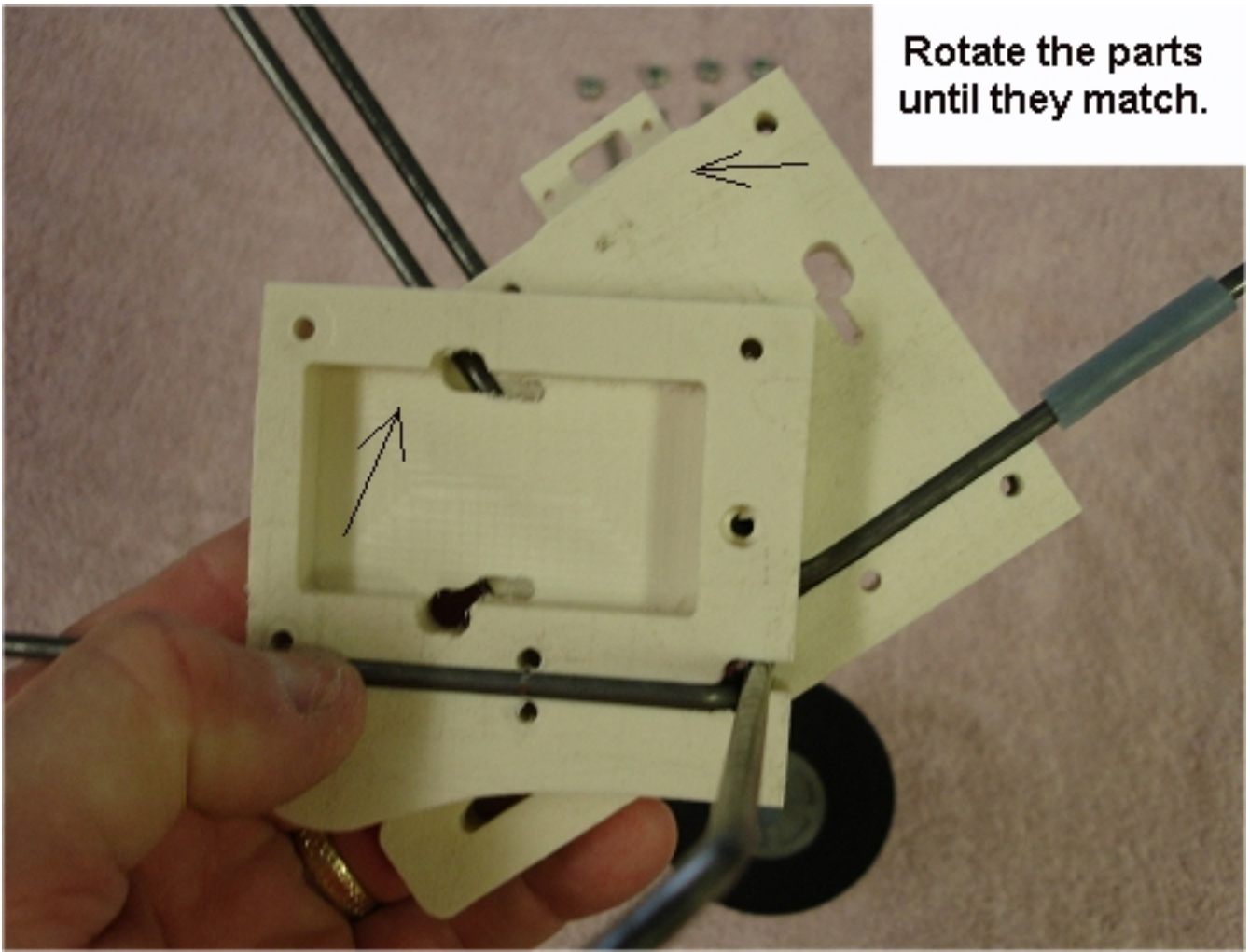

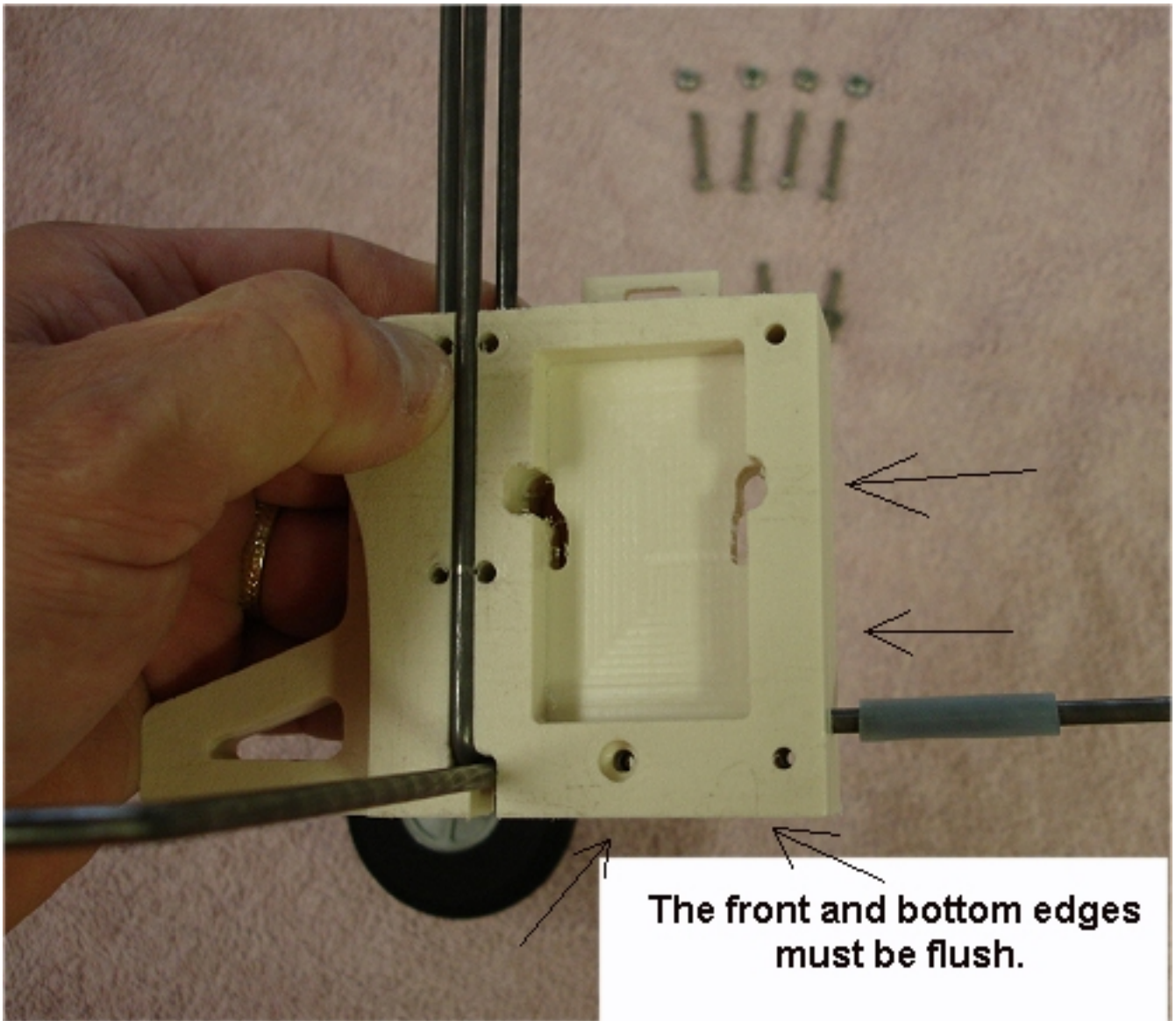

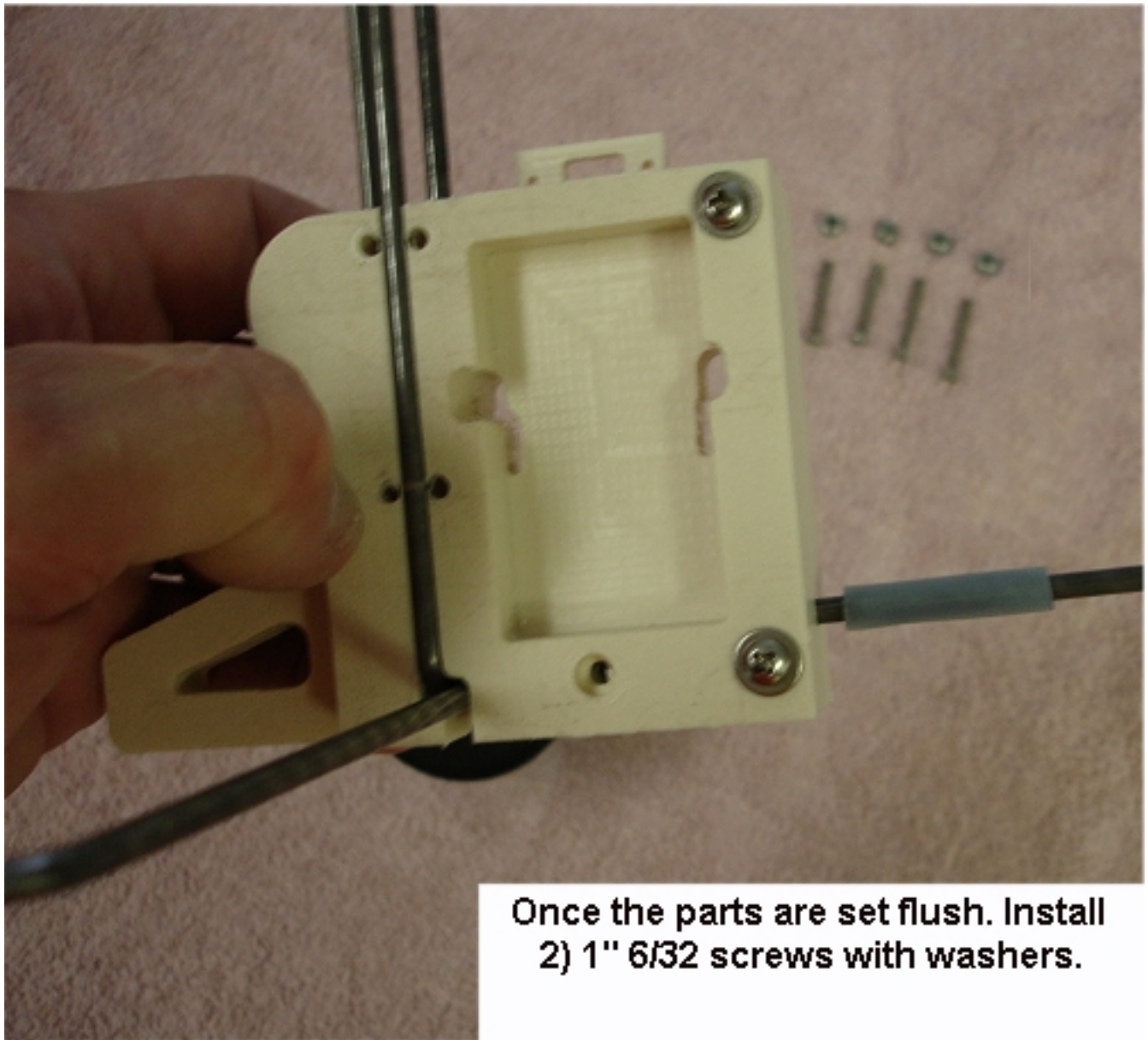

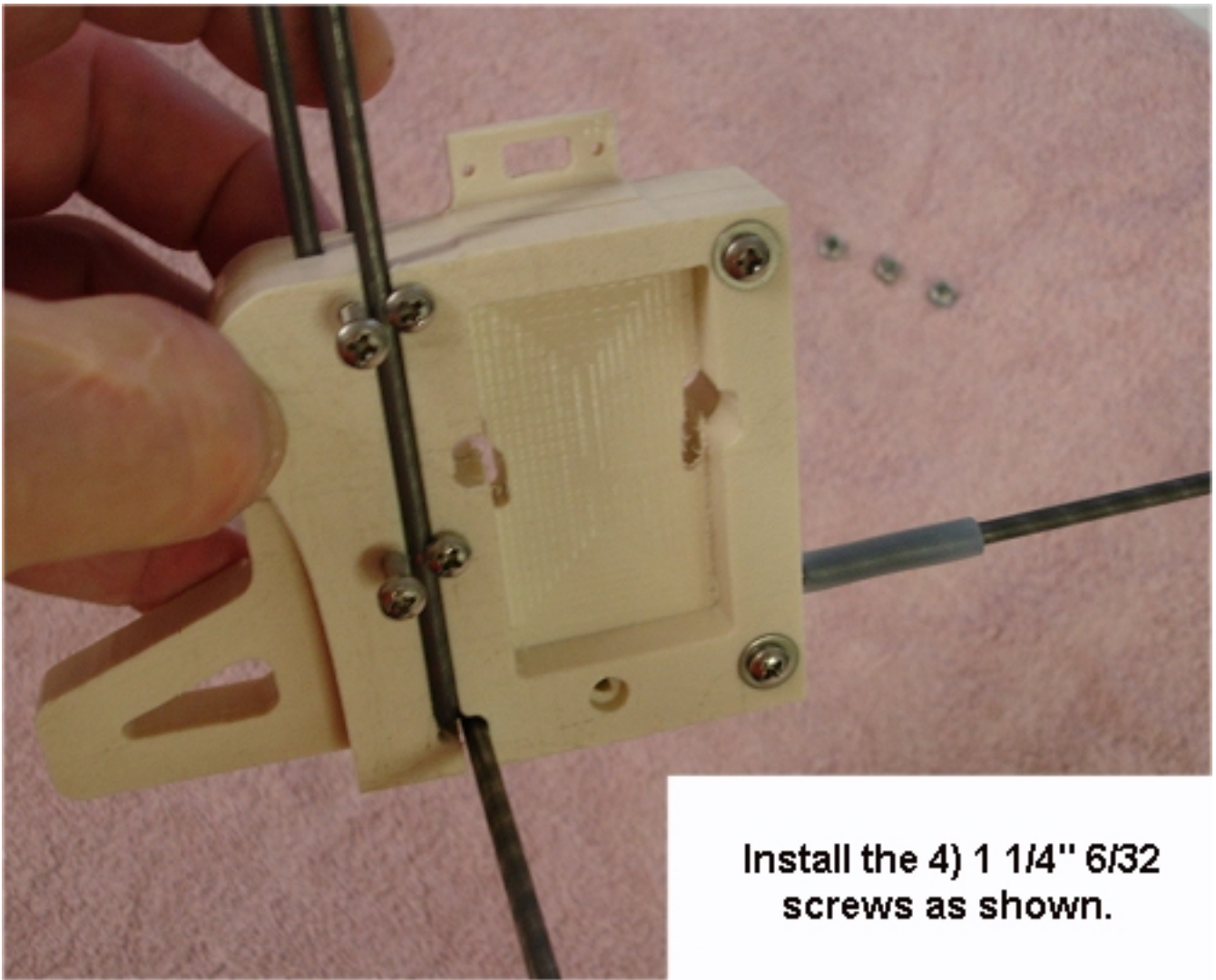

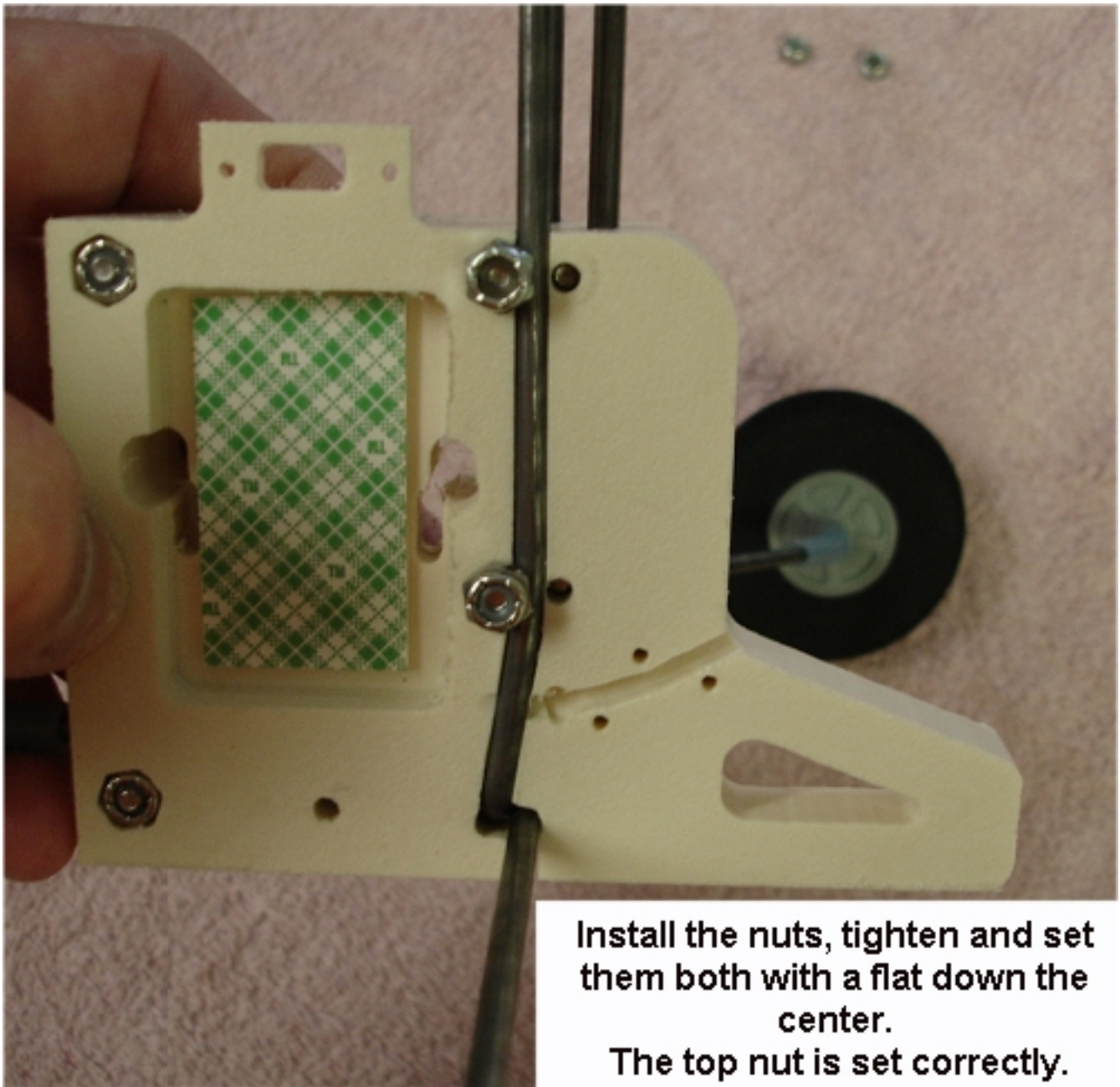

**Install the nuts, tighten and set them both with a flat down the center.  
The top nut is set correctly.**

